

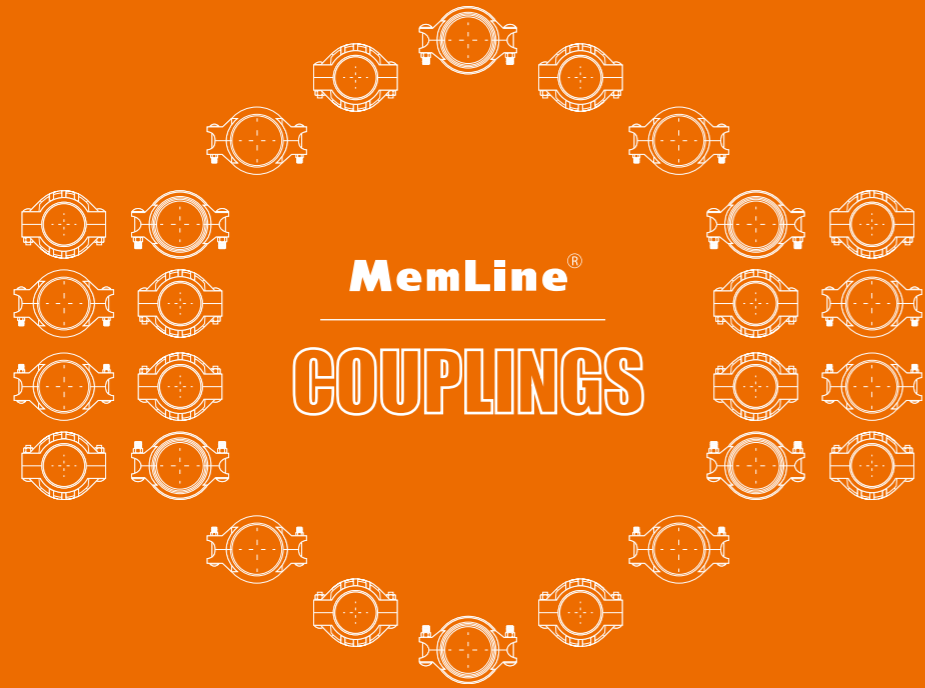

MemLine[®]



Flexible Pipe Couplings

Zhejiang Beeasy Mechanics Stock Co.,Ltd

Zhongyi Village, Lizhu Town, Keqiao District Shaoxing, Zhejiang | +86-0575-85787991 | info@memline.com | www.memline.com

Zhejiang Beeasy Mechanics Stock Co.,Ltd

Product Catalogue



Introduction



MemLine®, a trustable trademark of flexible couplings and pipe fittings since 2003, has been working for pipe solutions of water treatment systems from the start.

Having experienced for years in water treatment industry, MemLine's engineering team and technical experts know well about the piping systems, especially the RO systems of sea water desalination. Besides the supplies of materials, the team is qualified to help customers with solutions and supports to their projects.

The whole series of MemLine couplings cover the pressure grades 300psi, 450psi, 600psi, 1200psi, and 1500psi, with optional raw materials including SS304, SS316, duplex, super duplex, and composite plastic, which are applicable to kinds of systems and enable customers to choose the proper products according to different needs.

Here we promise, all the raw materials are complied with ASTM, all our own designs are complied with AWWA, all test methods are complied with ASME.

MemLine, a reliable choice for you.

PIPE COUPLINGS



STYLE B 300PSI - 450PSI
 3/4" - 12"
 SS304 / SS316 / SS316L / Duplex / Super Duplex



STYLE D 600PSI
 3/4" - 6"
 SS304 / SS316 / SS316L / Duplex / Super Duplex



STYLE E 1000PSI - 1200PSI
 3/4" - 12"
 SS304 / SS316 / SS316L / Duplex / Super Duplex



STYLE F 1500PSI
 3/4" - 6"
 SS304 / SS316 / SS316L / Duplex / Super Duplex



STYLE PP 100PSI - 300PSI
 3/4" - 8"
 PPO



STYLE PA 100PSI
 3/4" - 4"
 ABS

PIPE FITTINGS



END CAP TYPE M 1200PSI
 3/4" - 12"
 SS304 / SS316 / Duplex / Super Duplex



BUTT-WELD PIPE TYPE C 600PSI - 1200PSI
 3/4" - 12"
 SS304 / SS316 / Duplex / Super Duplex



BUTT-THREAD PIPE TYPE A 600PSI - 1200PSI
 3/4" - 12"
 SS304 / SS316 / Duplex / Super Duplex



ELBOW & TEE 600PSI - 1200PSI
 1" - 24"
 SS304 / SS316 / Duplex / Super Duplex

Product Advantage

General Instruction of Piping Connection

Three methods are available in traditional metal piping connection:

WELDING / FLANGE / SCREW THREAD

While, COUPLINGS provide the fourth method to piping connection systems, as a faster, easier reliable and more economical way of jointing pipes, with no pollution to the environment at all during its installation.

The connecting way of couplings is to place an end groove on top of the outer wall of pipes, then joint the two pipes together by the connection of couplings.

Two processing methods of groove are available and specifications are according to AWWA norm - CUT GROOVE & ROLL GROOVE.

Benefits of grooved-end pipe flexible couplings connection compared with WELDING, FLANGE AND SCREW THREAD CONNECTION

Providing faster and safer installation when it is compared with WELDING

Eliminates the safety concerns due to easy installation.

Providing more secure and reliable performance when it is compared with FLANGE AND SCREW THREAD connection.

Easy installation, simple operation, significantly reducing the installation and maintenance cost.



Features of Memline® Flexible Couplings

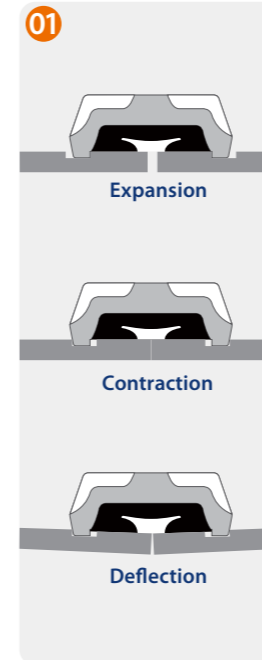

01 FLEXIBILITY

Memline® Flexible Couplings accommodate pipe with contraction, expansion and deflection. It accommodates the axial and radial movement which caused by vibration and pressure of system during the installation and operation of piping system.

02 NOISE AND VIBRATION ATTENUATION

Due to the independent grooved-end pipe design of Memline® Flexible Couplings, sealed by a EPDM Gasket and unified by an externally bolted coupling housing, noise and vibration transmission occurred during the installation and operation can be reduced or absorbed efficiently.

03 SEISMIC STRESS ABSORPTION

The full engagement of the housing keys into grooves around the full pipe circumference provides significant pressure restraint and load capabilities of pipe end to withstand pipe movement from various internal and external sources.

04 EASY AND SIMPLE INSTALLATION & MAINTENANCE

Only simple tool is required for installation. The grooved system allows full rotation of the pipe and system components before tightening so that proper alignment can be achieved, elimination mate-up problems and field rework. Significantly reduce the installation, maintenance, and system expansion cost.

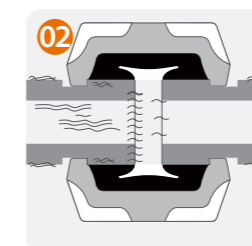

Noise and Vibration Attenuation

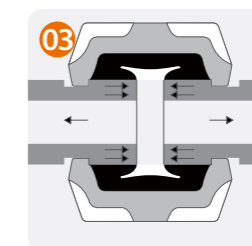

Seismic Stress Absorption



Alignment Ease

STYLE B

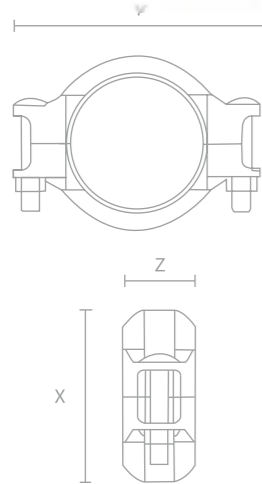

Designed for Low Pressure System

Pressure Rating	300psi (21bar) - 450psi (31bar)
Sizes	3/4" - 12"
Housing Material	304, grade CF8, in compliance with ASTM A351.
	316, grade CF8M, in compliance with ASTM A351.
	316L, grade CF3M, in compliance with ASTM A351.
	Duplex/2205, grade CD3MN, in compliance with ASTM A-890 Grade 4A.
	Super duplex, grade CE8MN, in compliance with ASTM A-890 Grade 4A.
	Super duplex/2507, grade CE3MN, in compliance with ASTM A-890 Grade 5A.
Bolts	304SS or 316SS, in compliance with ASTM F593, Group 2, Condition CW.
Nuts	304SS, or 316SS standard, silicone bronze optional.
Gasket	EPDM rubber, C-shaped type standard, F-shaped type optional.

Application

- Brackish watertreatment
- MF
- UF
- Membrane filtration
- Permeate
- Waste water
- Low pressure RO

Promise to Rated Pressure

Pressure ratings designed and tested in accordance with ASME Section VIII Division 1, the pressure vessel test method.

Promise to Installation Performance

End-groove specification designed in strict accordance with AWWA C606-97.

Main Parameters

Nominal Sizes	DN inch	20 3/4	25 1	40 1 1/2	50 2	65 2 1/2	65 2 1/2	80 3	100 4	125 5	150 6	200 8	250 10	300 12
	X mm inch	46.2 1.82	54.6 2.12	94 2.56	94 3.70	99.3 3.66	102.30 4.03	109.2 4.30	144.00 5.7	175.00 6.89	200 7.87	254 10.0	310 12.2	370 14.57
Dimensions	Y mm inch	73.7 2.90	82.4 3.21	117 4.60	134 5.27	134.6 5.30	137.60 5.42	147.3 5.80	181.60 7.2	213.00 8.39	245 9.65	303 11.93	362 14.25	421 16.5
	Z mm inch	42.7 1.68	42 1.64	43.8 1.71	45.5 1.79	47 1.85	47.00 1.85	47 1.85	49.20 1.9	49.20 1.94	49.2 1.93	57.2 2.25	57.2 2.25	62 2.44
Approx Wgt. Each	Kg Lbs	0.33 0.73	0.35 0.77	0.57 1.26	0.74 1.63	0.98 2.15	0.98 2.16	1.06 2.33	1.40 3.1	1.9 4.18	2.2 4.85	3.9 8.60	5.3 11.7	16.2 35.7
Rated Pressure	psi bar	450 31	450 31	450 31	450 31	450 31	450 31	450 31	450 31	300 21	300 21	300 21	300 21	300 21

Note: The rated pressure applicable to cutting type groove, for rolling type groove, contact MemLine for details.

STYLE D

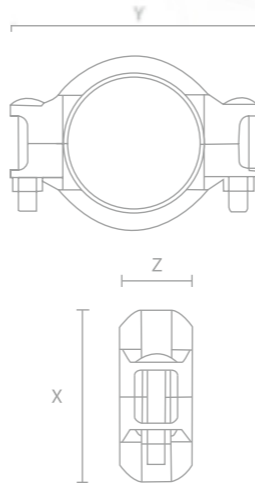

Designed for Medium Pressure System

Pressure Rating	600psi (40bar)
Sizes	3/4" - 6"
Housing Material	304, grade CF8, in compliance with ASTM A351.
	316, grade CF8M, in compliance with ASTM A351.
	316L, grade CF3M, in compliance with ASTM A351.
	Duplex/2205, grade CD3MN, in compliance with ASTM A-890 Grade 4A.
	Super duplex, grade CE8MN, in compliance with ASTM A-890 Grade 4A.
	Super duplex/2507, grade CE3MN, in compliance with ASTM A-890 Grade 5A.
Bolts	304SS or 316SS, in compliance with ASTM F593, Group 2, Condition CW.
Nuts	304SS, or 316SS standard, silicone bronze optional.
Gasket	EPDM rubber, C-shaped type standard, F-shaped type optional.

Application

- Brackish watertreatment
- Waste water treatment
- Medium pressure RO

Promise to Rated Pressure

Pressure ratings designed and tested in accordance with ASME Section VIII Division 1, the pressure vessel test method.

Promise to Installation Performance

End-groove specification designed in strict accordance with AWWA C606-97.

Main Parameters

Nominal Sizes	DN inch	20 3/4	25 1	40 1 1/2	50 2	65 2 1/2	65 2 1/2	80 3	100 4	125 5	150 6
	X mm inch	52.3 2.06	54.6 2.12	70.6 2.78	82.8 3.26	95.5 3.76	106.30 4.19	111.3 4.38	147 5.79	178.00 7.01	208 8.19
Dimensions	Y mm inch	81.3 3.33	84.6 3.21	103.1 4.06	117.4 4.62	137.2 5.40	142.80 5.62	149.8 5.90	195 7.68	218.00 8.58	272 10.7
	Z mm inch	42.7 1.68	42 1.64	43.8 1.71	47 1.85	47 1.85	47.00 1.85	47.0 1.85	52.1 2.05	52.10 2.05	52.1 2.05
Approx Wgt. Each	Kg Lbs	0.35 0.77	0.42 0.93	0.57 1.26	0.65 1.43	0.98 2.15	1.30 2.86	1.80 3.96	2.7 5.95	3.6 7.92	4.5 9.92
Rated Pressure	psi bar	600 40	600 40	600 40	600 40	600 40	600 40	600 40	600 40	600 40	600 40

Note: 1. The rated pressure applicable to cutting type groove, for rolling type groove, contact MemLine for details.
2. For the couplings Style D available in 8", 10", and 12", contact MemLine for details.

STYLE E

Designed for High Pressure System

Pressure Rating	1000psi (70bar) - 1200psi (83bar)
Sizes	3/4" - 12"
Housing Material	304, grade CF8, in compliance with ASTM A351.
	316, grade CF8M, in compliance with ASTM A351.
	316L, grade CF3M, in compliance with ASTM A351.
	Duplex/2205, grade CD3MN, in compliance with ASTM A-890 Grade 4A.
	Super duplex, grade CE8MN, in compliance with ASTM A-890 Grade 4A.
	Super duplex/2507, grade CE3MN, in compliance with ASTM A-890 Grade 5A.
Bolts	304SS or 316SS, in compliance with ASTM F593, Group 2, Condition CW.
Nuts	304SS, or 316SS standard, silicone bronze optional.
Gasket	EPDM rubber, C-shaped type standard, F-shaped type optional.

Application

- Brackish watertreatment
- Waste water treatment
- High pressure RO

Promise of Rated Pressure

Pressure ratings designed and tested in accordance with ASME Section VIII Division 1, the pressure vessel test method.

Promise to Installation Performance

End-groove specification designed in strict accordance with AWWA C606-97.

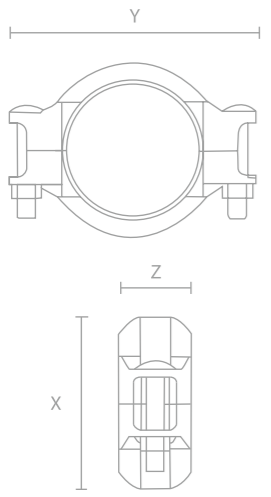

Main Parameters

Nominal Sizes	DN	20	25	40	50	65	65	80	100	125	150	200	250	300
	inch	3/4	1	1 1/2	2	2 1/2	2 1/2	3	4	5	6	8	10	12
Dimensions	X	mm	51	57.4	78	90	102	110.30	120	152	180.00	212	266	330
	inch		2.0	2.26	3.04	3.54	4.0	4.34	4.72	5.98	7.09	8.35	10.47	13.00
Dimensions	Y	mm	82	87.1	107	122	137	156.80	160	186	221.00	263	331	388
	inch		3.3	3.43	4.17	4.81	5.38	6.17	6.30	7.33	8.7	10.35	13.03	15.28
Dimensions	Z	mm	43	42	43	46	47	47.00	47	51	52.10	51	63	65
	inch		1.71	1.64	1.71	1.79	1.85	1.9	1.85	2.02	2.05	2.02	2.48	2.56
Approx Wgt. Each	Kg	0.53	0.56	0.78	1.22	1.44	1.60	1.9	2.68	3.9	5.2	1.2	15.4	20.3
	Lbs	1.2	1.24	1.71	2.68	3.2	3.52	4.18	5.9	8.58	11.2	24.1	33.1	43.6
Rated Pressure	psi	1200	1200	1200	1200	1200	1200	1200	1200	1200	1200	1200	1000	1000
	bar	83	83	83	83	83	83	83	83	83	83	83	70	70

Note: The rated pressure applicable to cutting type groove, for rolling type groove, contact MemLine for details.

STYLE F

Designed for High Pressure System

Pressure Rating	1500psi (104bar)
Sizes	3/4" - 6"
Housing Material	304, grade CF8, in compliance with ASTM A351.
	316, grade CF8M, in compliance with ASTM A351.
	316L, grade CF3M, in compliance with ASTM A351.
	Duplex/2205, grade CD3MN, in compliance with ASTM A-890 Grade 4A.
	Super duplex, grade CE8MN, in compliance with ASTM A-890 Grade 4A.
	Super duplex/2507, grade CE3MN, in compliance with ASTM A-890 Grade 5A.
Bolts	304SS or 316SS, in compliance with ASTM F593, Group 2, Condition CW.
Nuts	304SS, or 316SS standard, silicone bronze optional.
Gasket	EPDM rubber, C-shaped type standard, F-shaped type optional.

Application

- Brackish watertreatment
- Waste water treatment
- High pressure RO

Promise to Rated Pressure

Pressure ratings designed and tested in accordance with ASME Section VIII Division 1, the pressure vessel test method.

Promise to Installation Performance

End-groove specification designed in strict accordance with AWWA C606-97.

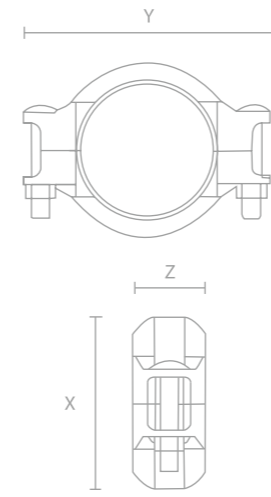

Main Parameters

Nominal Sizes	mm	20	25	40	50	65	80	100	150
	inches	3/4	1	1 1/2	2	2 1/2	3	4	6
Dimensions	X	mm	53	61	80	92	104	122	154
	inch		2.08	2.4	3.14	3.62	4.1	4.8	6.06
Dimensions	Y	mm	82	89	109	124	138	161	188
	inch		3.3	3.5	4.29	4.88	5.38	6.3	7.4
Dimensions	Z	mm	43	43	43	46	47	47	51
	inch		1.69	1.7	1.71	1.79	1.85	1.85	2.02
Approx Wgt. Each	Kg	0.53	0.57	0.8	1.26	1.48	2.01	2.72	5.28
	Lbs	1.2	1.25	1.75	2.76	3.24	4.4	5.98	11.3
Rated Pressure	psi	1500	1500	1500	1500	1500	1500	1500	1500
	bar	104	104	104	104	104	104	104	104

Note: The rated pressure applicable to cutting type groove, for rolling type groove, contact MemLine for details.

STYLE PP/PA

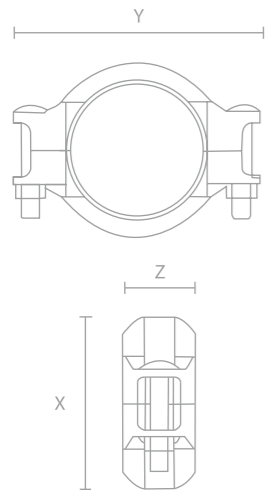

Designed for Low Pressure System

Pressure Rating STYLE PP	100psi (7bar) - 300psi (21bar)
Pressure Rating STYLE PA	100psi (7bar)
Sizes	STYLE PP: 3/4" - 8" / STYLE PA: 3/4" - 4"
Housing Material	STYLE PP: PPO / STYLE PA: ABS
Bolts	304SS or 316SS, in compliance with ASTM F593, Group 2, Condition CW.
Nuts	304SS, or 316SS standard, silicone bronze optional.
Gasket	EPDM rubber, C-shaped type standard, F-shaped type optional.

Application

- Brackish watertreatment
- MF
- UF
- Membrane filtration
- Permeate
- Waste water
- Low pressure RO

Advantages

- Complete resistance of corrosion
- Color: Excellent resistance of UV
- Housing: Non-absorption of water
- Light weight
- Long lifetime

Promise to Rated Pressure

Pressure ratings designed and tested in accordance with ASME Section VIII Division 1, the pressure vessel test method.

Promise to Installation Performance

End-groove specification designed in strict accordance with AWWA C606-97.

Main Parameters

Nominal Sizes	DN	20	25	40	50	65	80	100	125	150	200
	inch	3/4	1	1 1/2	2	2 1/2	3	4	5	6	8
	X	mm	46.2	66.4	68.0	80.3	94.5	110	156	192	209
		inch	1.82	2.61	2.56	3.16	3.63	4.30	6.14	7.55	8.22
Dimensions	Y	mm	79	91.4	104	114.3	134.6	147.3	208	248	241
		inch	2.99	3.60	4.09	4.50	5.30	5.80	8.19	9.76	9.48
	Z	mm	42.7	44.3	43.8	47.0	47.0	47	52	52	54
		inch	1.68	1.74	1.71	1.85	1.85	1.85	2.05	2.05	2.12
Approx Wgt. Each	Kg	0.33	0.35	0.4	0.45	0.65	0.85	0.95	1.15	1.61	2.1
Rated Pressure STYLE PP	psi	300	300	300	300	300	300	300	300	300	300
	bar	21	21	21	21	21	21	21	21	21	21
Rated Pressure STYLE PA	psi	100	100	100	100	100	100	100			
	bar	7	7	7	7	7	7	7			

Note: The rated pressure applicable to cutting type groove, for rolling type groove, contact MemLine for details.

Pipe Fittings

END CAP TYPE M



Designed for High Pressure System

Pressure Rating	1200psi
Sizes	3/4" - 12"
Housing Material	304SS, grade CF-8, in compliance with ASTM A351, A743 & A744.
	316SS, grade CF-8M, in compliance with ASTM A351, A743 & A744.
	Duplex, grade CE8MN, in compliance with ASTM A-890 Grade 4A.
	Super duplex, grade CE3MN, in compliance with ASTM A-890 Grade 5A.

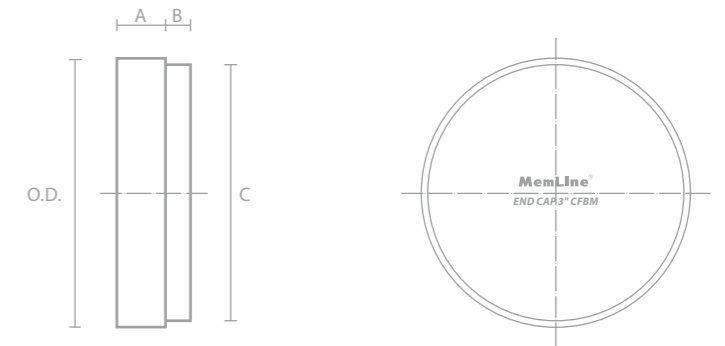

Main Parameters

Nominal Sizes	DN	DN20	DN25	DN32	DN40	DN50	DN65	DN80	DN100	DN150	DN200	DN250	DN300
Diameter of Nominal	Inch	3/4"	1	1-1/4	1-1/2	2	2-1/2	3	4	6	8	10	12
	C	Inch	0.94	1.19	1.54	1.78	2.25	2.72	3.34	4.33	6.46	8.44	10.56
		mm	23.9	30.2	39.0	45.1	57.2	69.1	84.9	110.1	164.0	214.4	268.3
Dimensions	B	Inch	0.31	0.31	0.31	0.31	0.31	0.31	0.31	0.37	0.37	0.43	0.51
		mm	7.9	7.9	7.9	7.9	7.9	7.9	7.9	9.5	9.5	11	13
	A	Inch	0.63	0.63	0.63	0.63	0.63	0.63	0.63	0.63	0.75	0.75	0.75
		mm	15.9	15.9	15.9	15.9	15.9	15.9	15.9	15.9	19	19	19
Approx Weight	lb	0.22	0.40	0.64	0.72	1.34	1.93	2.96	4.98	11.76	21.74	37.31	52.58
	kg	0.10	0.18	0.29	0.33	0.61	0.88	1.34	2.26	5.33	9.86	16.93	23.85

Pipe Fittings

GROOVED BUTT-WELD / THREAD PIPE



Designed for High Pressure System	
Pressure Rating	600psi, 1200psi
Sizes	3/4" - 12"
Housing Material	304SS, 316SS, duplex, super duplex optional

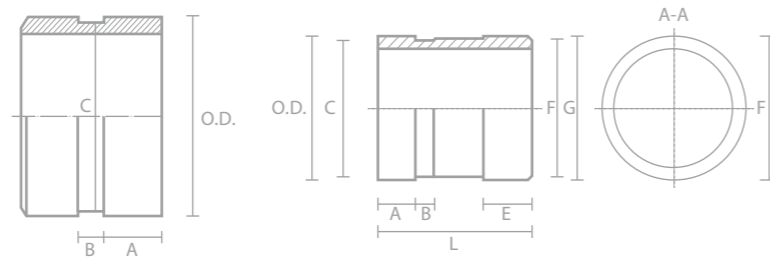

Main Parameters

Size of Nominal	O.D. and Tolerance			A(+0.015) (-0.030)	B(+0.031) (-0.015)	C		E	F	G	L
	Dia.	Tol. (+)	Tol. (-)			Dia.	Tol.(-)				
Inch	Inch	Inch	Inch	Inch	Inch	Inch	Inch	Inch	Inch	Inch	Inch
mm	mm	mm	mm	mm	mm	mm	mm	mm	mm	mm	mm
3/4"	1.050 26.9	0.010 0.25	0.010 0.25	0.625 15.88	0.313 7.95	0.938 23.83	0.015 0.38	0.57 14.5	0.98 25	3/4"	2.05 52
1"	1.315 33.4	0.013 0.33	0.013 0.33	0.625 15.88	0.313 7.95	1.190 30.23	0.015 0.38	0.67 17	1.26 32	1"	2.24 57
1-1/4"	1.660 42.4	0.016 0.41	0.016 0.41	0.625 15.88	0.313 7.95	1.535 38.99	0.015 0.38	0.75 19	1.57 40	1-1/4"	2.24 57
1-1/2"	1.900 48.3	0.019 0.48	0.019 0.48	0.625 15.88	0.313 7.95	1.775 45.09	0.015 0.38	0.75 19	1.81 46	1-1/2"	2.44 62
2"	2.375 60.3	0.024 0.61	0.024 0.61	0.625 15.88	0.313 7.95	2.250 57.15	0.015 0.38	0.91 23	2.28 58	2"	2.44 62
2-1/2"	2.875 73	0.029 0.74	0.029 0.74	0.625 15.88	0.313 7.95	2.720 69.09	0.018 0.46	0.98 25	2.91 74	2-1/2"	2.99 76
3"	3.500 88.9	0.035 0.89	0.031 0.79	0.625 15.88	0.313 7.95	3.344 84.94	0.018 0.46	1.06 27	3.43 87	3"	3.15 80
4"	4.500 114.3	0.045 1.14	0.031 0.79	0.625 15.88	0.375 9.53	4.334 110.08	0.020 0.51	1.18 30	4.49 113	4"	3.45 85
6"	6.625 168.3	0.062 1.60	0.031 0.79	0.625 15.88	0.375 9.53	6.455 163.96	0.022 0.56	0.022 0.56	0.433 11		
8"	8.625 219.1	0.062 1.60	0.031 0.79	0.750 19.05	0.438 11.13	8.441 214.4	0.022 0.56	0.022 0.56	0.511 13		
10"	10.75 273	0.062 1.60	0.031 0.79	0.750 19.05	0.500 12.70	10.562 268.28	0.027 0.69	0.027 0.69	0.511 13		
12"	12.75 323.9	0.062 1.60	0.031 0.79	0.750 19.05	0.500 12.70	12.531 318.29	0.030 0.76	0.030 0.76	0.511 13		

Pipe Fittings

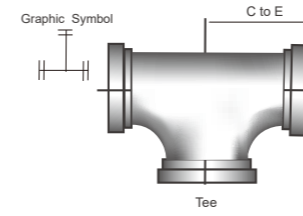
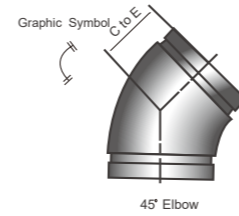
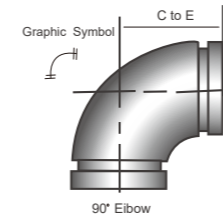

Main Parameters

Pipe Size	O.D.	Max. Work. Press.	Rated Work Press	90° Elbow			45° Elbow			Tee		
				Ctoe	Wt.	MResist	Ctoe	Wt.	MResist	Ctoe	Wt.	MResist
Inch	mm	MPa	MPa	mm	kg		mm	kg		mm	kg	
1"	33.5	4.4	2.1	57	0.3	0.4	44	0.3	0.2	57	0.5	1.3
1-1/4"	42.2	4.4	2.1	70	0.3	0.5	44	0.3	0.2	70	0.6	1.3
1-1/2"	48.3	4.4	2.1	70	0.4	0.7	44	0.3	0.3	70	0.6	1.5
2"	57	4.4	2.1	83	0.6	1.1	51	0.4	0.5	83	0.7	2.6
	60.3	4.4	2.1	83	0.6	1.1	51	0.4	0.5	83	1.5	2.6
2-1/2"	73	4.4	2.1	95	0.9	1.3	57	0.7	0.7	95	1.7	3.3
	76.1	4.4	2.1	95	0.9	1.5	63.5	1.2	0.8	108	2.4	4.0
3"	88.9	4.4	2.1	108	1.7	1.5	63.5	1.2	0.8	108	2.4	4.0
4"	108	4.4	2.1	127	2.5	2.1	76	1.9	1.0	127	3.7	4.9
	114.3	4.4	2.1	127	2.7	2.1	76	1.8	1.0	127	3.7	4.9
5"	133	4.4	2.1	140	4.1	2.6	83	2.4	1.3	140	5.9	6.4
	139.7	4.4	2.1	140	4.8	2.6	83	2.8	1.3	140	5.7	6.4
	141.3	4.4	2.1	140	5.0	2.6	83	3.0	1.3	140	6.0	7.6
6"	159	4.4	2.1	165	5.9	3.0	89	3.8	1.5	165	9.4	7.6
	165.1	4.4	2.1	165	6.8	3.0	89	3.8	1.5	165	9.8	7.6
	168.3	4.4	2.1	165	6.6	3.0	89	4.1	1.5	165	9.3	7.6
8"	219	4.4	2.1	197	12.0	4.0	108	7.6	2.0	197	13.7	10.1
10"	273	2.5	1.9	229	21.7	7.0	121	12.6	3.5	230	31.1	14.1
12"	323.9	2.5	1.9	250	34.6	8.0	133	16.2	4.1	245	40.5	16.3
	325	2.5	1.9	254	37.8	8.7	133	16.8	4.4	254	47.3	17.5
14"	355.6	2.1	1.6	356	60.0	9.5	147	23	4.9	280	63	19.5
	377	2.1	1.6	377	80.0	10.6	156	26	5.3	290	68	21.1
16"	406.4	2.1	1.6	406	93	11.5	168	40	5.8	305	77	23
	426	2.1	1.6	426	105	12.3	177	55.4	6.2	320	85	24.6
18"	457.2	2.1	1.6	457	135	13.6	190	62	6.5	356	110	26.5
20"	508	2.1	1.6	508	160	15.4	210	76	7.3	381	148	30.2
	530	2.1	1.6	530	185	16.2	220	90	8.1	390	174	32.3
24"	609.6	2.1	1.6	610	235	18.6	253	106	10.0	432	220	37.5
	630	2.1	1.6	630	254	20.1	262	114	11.1	445	245	40.1

Gasket Styles

Memline® gasket is designed to function in wide applications during the the whole working period. Most sealing materials that meet application requirements are available.



Standard C-shaped Type



FlushSeal F-shaped Type

Memline® gasket is pressure responsive. It achieves an intial seal as it is positioned to the pipe ends, in which way it realises its sealing efficiency. The gasket is positioned with housing around and into the grooves. The exlastic gasket adjusts to the cavity of the housing and is further pressed, as housing tightened. It strengthens its sealing against pipelines.

These characteristics contribute to a permanent and leakless triple seal with the piping materials including cast iron, stainless steel, aluminum, PVC and copper. Piping pressure enhances the sealing through joint actions of gasket elasticity, housing reinforcement and pressure action upon the lips.

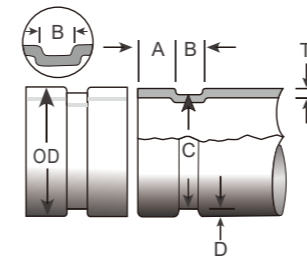

STANDARD ROLL / CUT GROOVE PIPE SPECIFICATION FOR FLEXIBLE COUPLINGS

Roll Grooving Dimension

Nomina Size	Tolerance for outer diameter pipe			Gasket Seat A	Grv. Width B	Groove Dia.-C		Groove Depth D	Min.Wall Thickness T	
	Basic OD	Tol.				Basic	Tolerance			
mm	in	mm	mm	mm	± 0.03mm	± 0.03mm	mm	mm	mm	
20	3/4	26.90	0.25	0.25	15.88	7.95	23.83	-0.38	1.42	2.87
25	1	32.00	0.33	0.33	15.88	7.95	28.90	-0.38	1.60	3.38
25	1	33.70	0.33	0.33	15.88	7.95	30.23	-0.38	1.60	3.38
32	1-1/4	42.40	0.41	0.41	15.88	7.95	38.99	-0.38	1.60	3.56
40	1-1/2	48.30	0.48	0.48	15.88	7.95	45.09	-0.38	1.60	3.68
50	2	60.30	0.61	0.61	15.88	7.95	57.15	-0.38	1.60	3.91
65	2-1/2	73.00	0.74	0.74	15.88	7.95	69.09	-0.46	1.98	4.78
80	3	88.90	0.89	0.79	15.88	7.95	84.94	-0.46	1.98	4.78
100	4	114.30	0.89	0.79	15.88	9.53	110.08	-0.51	2.11	5.16
125	5	141.30	1.0	0.79	15.88	9.53	137.03	-0.51	2.13	5.16
150	6	168.30	1.60	0.79	15.88	9.53	163.96	-0.56	2.16	5.56
200	8	219.10	1.60	0.79	19.05	11.13	214.40	-0.64	2.34	6.05
250	10	273.00	1.60	0.79	19.05	12.70	268.28	-0.69	2.39	6.35
300	12	323.90	1.60	0.79	19.05	12.70	318.29	-0.76	2.77	7.09

Cut Grooving Dimension

Nomina Size	Tolerance for outer diameter pipe			Gasket Seat A	Grv. Width B	Groove Dia.-C		Groove Depth D	Min.Wall Thickness T	
	Basic OD	Tol.				Basic	Tolerance			
mm	in	mm	mm	mm	± 0.03mm	± 0.03mm	mm	mm	mm	
20	3/4	26.90	0.25	0.25	15.88	7.95	23.83	-0.38	1.42	2.87
25	1	32.00	0.33	0.33	15.88	7.95	28.90	-0.38	1.60	3.38
25	1	33.70	0.33	0.33	15.88	7.95	30.23	-0.38	1.60	3.38
32	1-1/4	42.40	0.41	0.41	15.88	7.95	38.99	-0.38	1.60	3.56
40	1-1/2	48.30	0.48	0.48	15.88	7.95	45.09	-0.38	1.60	3.68
50	2	60.30	0.61	0.61	15.88	7.95	57.15	-0.38	1.60	3.91
65	2-1/2	73.00	0.74	0.74	15.88	7.95	69.09	-0.46	1.98	4.78
80	3	88.90	0.89	0.79	15.88	7.95	84.94	-0.46	1.98	4.78
100	4	114.30	0.89	0.79	15.88	9.53	110.08	-0.51	2.11	5.16
125	5	141.30	1.0	0.79	15.88	9.53	137.03	-0.51	2.13	5.16
150	6	168.30	1.60	0.79	15.88	9.53	163.96	-0.56	2.16	5.56
200	8	219.10	1.60	0.79	19.05	11.13	214.40	-0.64	2.34	6.05
250	10	273.00	1.60	0.79	19.05	12.70	268.28	-0.69	2.39	6.35
300	12	323.90	1.60	0.79	19.05	12.70	318.29	-0.76	2.77	7.09

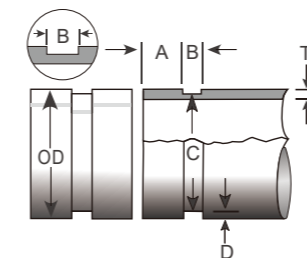

SELECTION GUIDE

Grade	E	T	O
* Temp. Range	-30°F to +230°F -34°C to +110°C	-20°F to +180°F -29°C to +82°C	+20°F to +300°F -C7°C to +149°C
Compound	EPDM	Nitrile	Fluoroelastomer
General Service Recommendations	Recommended for hot water service within the specified temperature range plus a variety of dilute acids,oil-free air and many chemical services. UL classified in accordance with ANSI/NSF 61 for cold +86°F/+30°C and hot +180°F/+82°C potable water service.	Recommended for petroleum products, hydrocarbons,air with oil vapors, vegetable and mineral oils within the specified temperature range; not recommended for hot dry air over +140°F/+60°C and water over +150°F/+66°C.	Recommended for many oxidizing acids, petroleum oils, halogenated hydrocarbons, lubricants, hydraulic fluids, organic liquids and air with hydrocarbons.
	NOT RECOMMENDED FOR PETRO-LEUM SERVICES.	NOT RECOMMENDED FOR HOT WATER SERVICES.	NOT RECOMMENDED FOR HOT WATER SERVICES.